

DewPro[®] MMY 35

The DewPro[®] MMY 35 is a compact, trace moisture transmitter probe designed to measure the dew point of dry air systems. The microprocessor-controlled DewPro MMY 35 provides a 4-20mA output signal that corresponds to the measured dew point.

The MMY 35 provides a measurement range of -90°C to +10°C (-130°F to +50°F) with ±2°C (±3.6°F) accuracy, and a proven, planar capacitive sensor. The instrument can be configured and controlled with a PC using DewPro Communication software. This software permits the user to set the dew point range, adjust the loop current and read the dew point. The MMY 35 can interface with a PC via an 8 pin connector using 2 pins for the RS 485 communication and 2 pins for the current loop connected to 24V DC power supply. All wetted parts are of 316 stainless steel except the sensor and its ceramic feed-through mount. The housing is of anodized aluminum. A three meter long, eight core cable is optional.



Features:

- 4 to 20 mA loop-powered dry air streams
- Planar capacitive gold/aluminum sensor
- Designed to meet the needs of OEM customers

Options:

- DewPro Communication Software
- Eight-core connection cable (specify length)
- External display available with loop-power supply and alarm contacts

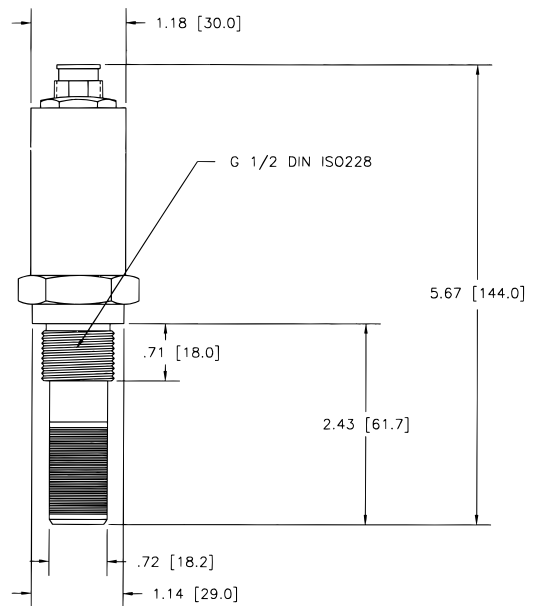

Ordering Information: See page 11

Dimensions/Specifications

Supply Power:	24 V DC nominal (9 to 32 V DC)	Maximum Relative Humidity:	50% at dew point temperatures > 0°C (32°F)
Current Loop:	4 mA to 20 mA corresponding to a standard dew point range of -90°C to +10°C (-130°F to +50°F)	Temp. Coefficient:	<0.2°C/°C (<0.2°F/°F)
Communication:	RS 485, DewPro protocol	Ambient and Storage Temperature:	-40°C (-40°F) to +50°C (+122°F)
Cable Connector:	Rating IP 65; Pins 1 (+) (red) and 2 (-) (black) = current loop supply power; 3 (-) (brown) and 4 (+) (yellow) = RS 485 communication. Pin 5 through 8 (green, white, orange, blue) are not being used for the loop powered version.	Nominal Operating Temperature:	-20°C (-4°F) to +40°C (+104°F)
Sensing Element:	Planar gold/aluminum oxide, capacitance principle	Maximum Operating Pressure:	150 psig (10 bar)
Calibration Range:	-90°C to +10°C (-130°F to +50°F) dew point temperature	Helium Leak-rate:	< 10 ⁻⁶ mbar l/s
Recommended Recalibration Cycle:	12 to 24 months, depending on application and required accuracy	Maximum Gas Velocity:	50 m/s at 1 bar, 5 m/s at 10 bar
Calibration Accuracy:	±2°C (±3.6°F) dew point at 20°C (68°F) ambient temperature	Probe Mounting Adapter:	Stainless steel 316 (1.4571) with G 1/2 thread (DIN/ISO 228) and O-ring seal
Repeatability:	±1°C (±1.8°F)	Rating:	IP 40
		Wrench Width:	30 mm
		Protection From Particles:	Protective cap with 10 micron filter
		Weight:	0.55 lb (250 grams)